

VEHICLE TYPE

- Fire Fighting Vehicles
- Road Service Vehicles

TRANSMISSION CODE

UARA.801 is the first member of 800 Series. 800 KGM vertical Split Shaft PTO is designed for medium duty trucks with 3-stage. Pump&Roll featured gearbox can be installed as horizontal also. It can provide 100% of input speed. Control system can be pneumatic or mechanic. PTO shaft can be at differential side or cabin side. Second PTO output is an option. In case of double PTO, the output is requested, PTO outputs can be shifted independently. PTO outputs can be design with all ISO standard flanges as well as suitable housing for any kind of hydraulic pump. The cooling system can be mount on the gearbox. Engage/Disengage sensor can be installed to observe, if PTO is engaged or not, also RPM counter is another option. In case of drum brake is located on the behind of the main transmission, UARA.801 can be designed with drum brake if requested.

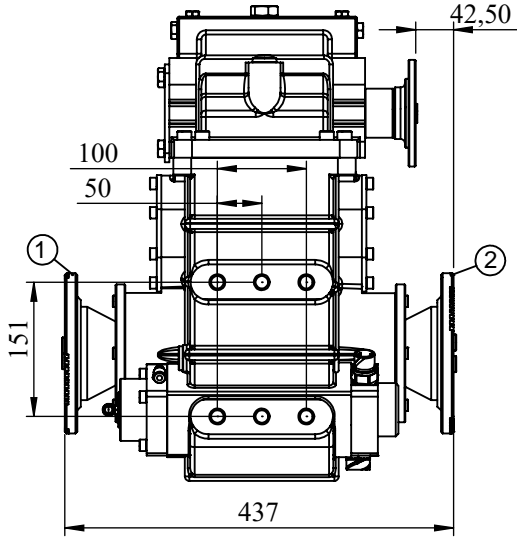
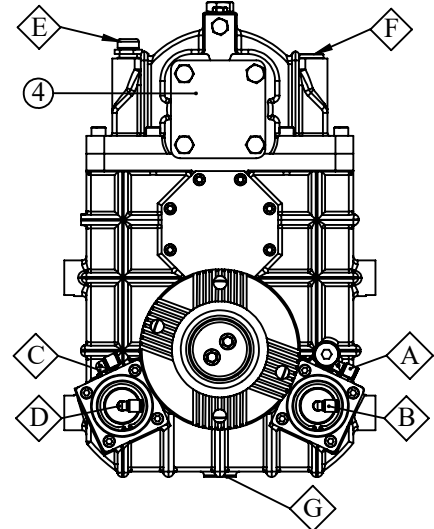
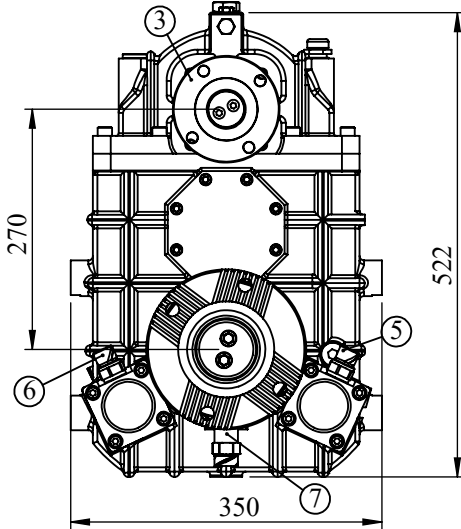

- | | |
|----|--|
| ① | Main Gearbox Input Flange (ISO 7646 - 7647- 8667) |
| ② | Differential Output Flange (ISO 7646 - 7647- 8667) |
| ③ | 1st. Equipment Output |
| ④ | 2nd. Equipment Output |
| ⑤ | Equipment On/Off Sensor |
| ⑥ | Main Drive On/Off Sensor |
| ⑦ | RPM Counter |
| ⬡A | Inter Air Engages The Main Drive |
| ⬡B | Inter Air Disables The Main Drive |
| ⬡C | Inter Air Engages The Equipment |
| ⬡D | Inter Air Disables The Equipment |
| ⬡E | Air Plug |
| ⬡F | Oil Filler Plug |
| ⬡G | Oil Drain Plug |

TECHNICAL VALUES

| | MAX VALUES | RATIO | WORKING RPM RANGE (MAX) |
|-------|---------------|--|----------------------------|
| ① & ② | 7845 Nm | 1/1 | 2500 - 3500 rpm |
| ③ | 135 kW | 1/1 - 1/1.2 - 1/1.4 - 1/1.6 1/1.84 - 1/2.25 | 2500 - 3500 rpm |
| | | | |

* Output Power ; The rpm and output power may vary. Contact KOZMAKSAN for exact working values.

| | | | |
|--------------------------------------|-----------|----------------------|----------------------------|
| Optimum Working Temperature | 25° - 70° | WEIGHT | 85 Kg |
| Short-term Working Temperature | 75° - 80° | BODY MATERIAL | Etial-171 (G-AISi10Mg) |
| Risky Working Temperature | 80° - | OIL TYPE & AMOUNT | SAE 90 - 4,5 Lt |

